

\_\_\_\_Macclesfield\_\_\_\_  
W E A V E R   G R E E N



# Say hello Macclesfield.

3 bedroom  
stylish new homes  
from £71,250\*

Weaver Green has two new build shared ownership homes on offer located on the outskirts of the market town of Macclesfield, set on the doorstep of the Peak District. So if you're looking to take your first step on to the property ladder, this is the place for you!

## Be quick.

[geckohomes.co.uk](https://geckohomes.co.uk)

\*Price based on 25% Shared Ownership and a 95% LTV mortgage. Properties are bought as leasehold. These houses are on offer to those who have a 'local connection'. This means that if you already live, work, have children in school, or have a family living in Cheshire East, then you likely meet the criteria to buy here. Full terms and conditions apply, for more information speak to our team.

—Macclesfield—  
WEAVER GREEN

where you'll want to live. **GECKO™**

# Weaver Green

## Development Plan

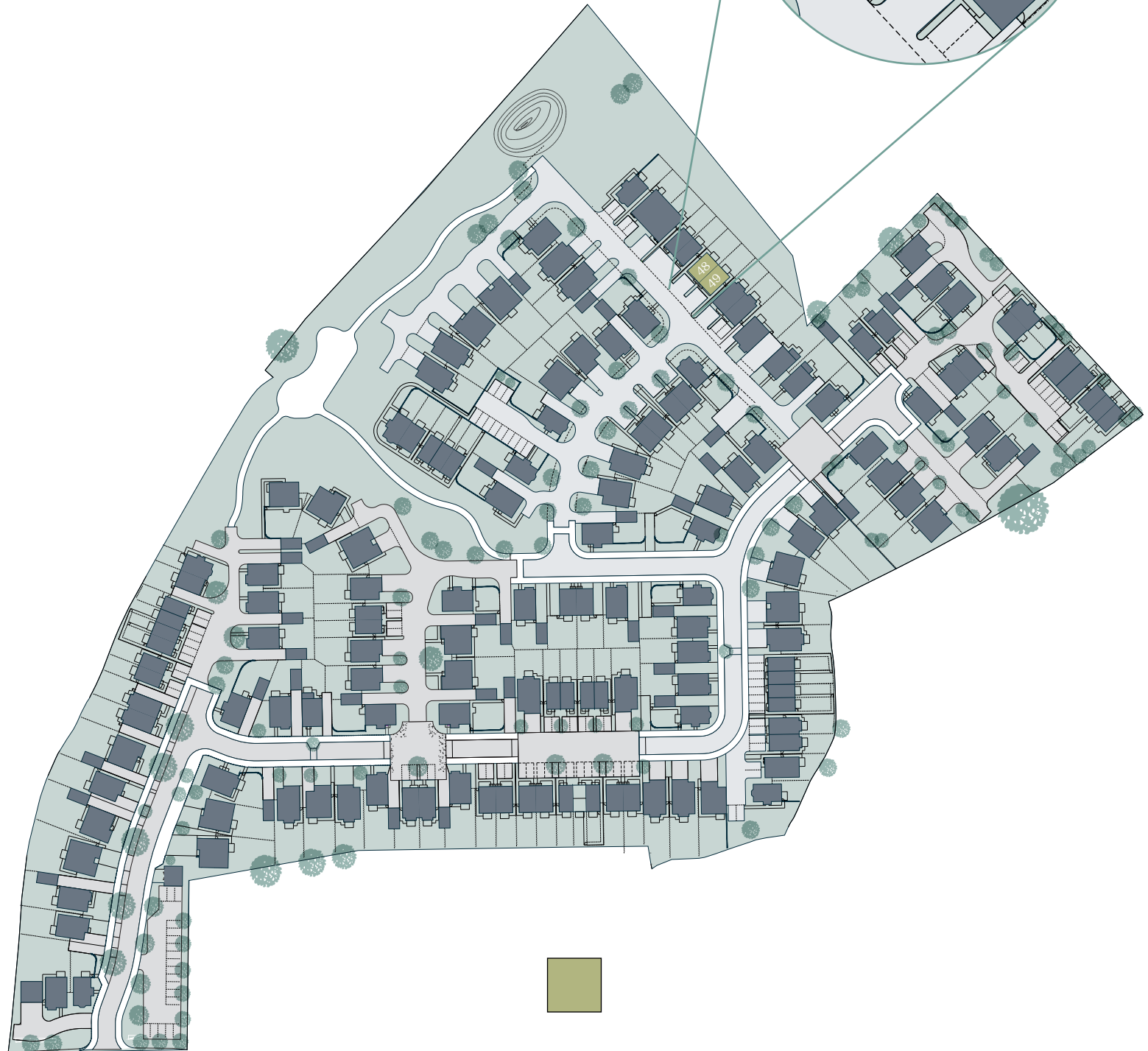
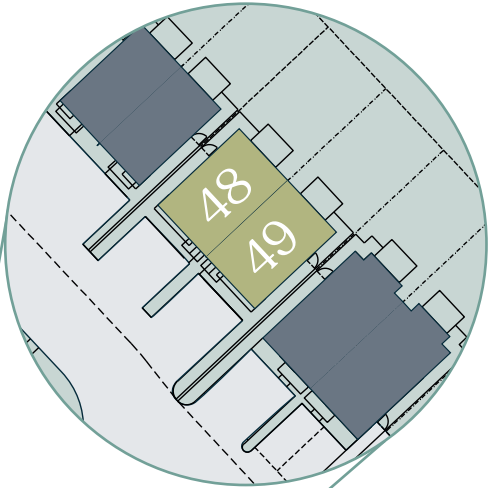

3 Bedroom House  
The Tailor

The Tailor

# 3 Bedroom House

Plots 48 & 49\*

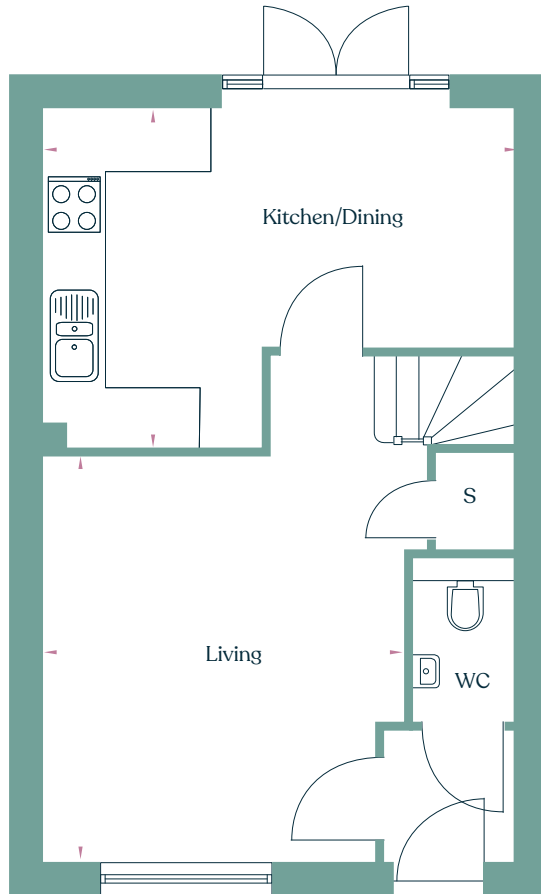

Ground floor

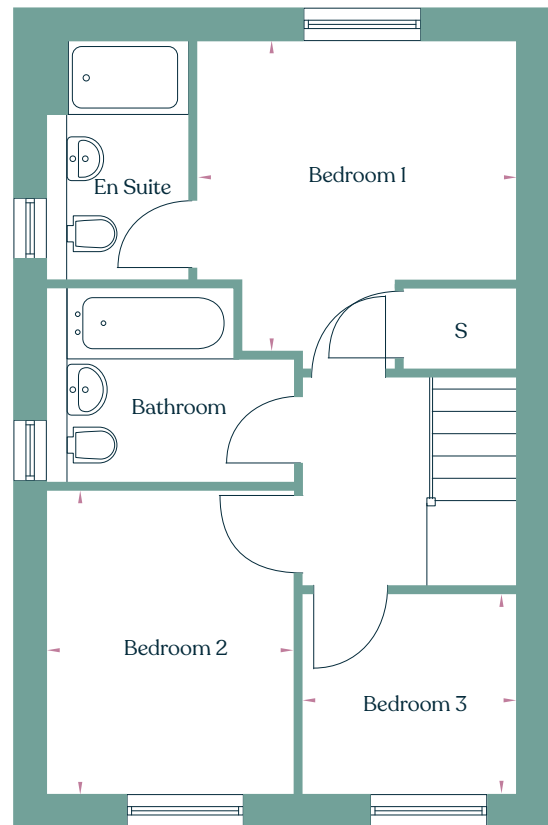

First Floor

Kitchen/Dining	4.78m x 3.45m
Living	5.14m x 3.9m
WC	1.66m x 1.01m
Bedroom 1	3.36m x 3.29m
En Suite	2.43m x 1.40m
Bedroom 2	3.09m x 2.52m
Bedroom 3	2.17m x 2.04m
Bathroom	2.52m x 1.97m

Total 74.5m<sup>2</sup>

S = Store \* = Handed layout of the plan shown above





Computer generated image of previous phase

# Specification

## The Tailor

### Kitchen/diner

- Integrated fan assisted oven
- Extractor fan
- Fully fitted kitchen units and worktop
- Downlights to kitchen area only

### Bathroom

- Contemporary, stylish bathroom suites
- En-suites fitted to selected house types
- Over bath shower fitted to main bathrooms
- Towel rail

### General

- Spacious and airy layouts
- Double glazing throughout
- Stylish white six panel doors
- Non-slip vinyl flooring to ground-floor WC, bathroom and kitchen area only
- Additional BT point in primary bedroom
- Ultrafast fibre broadband connection
- Turfed back garden
- Parking for all properties

Visit:  
[www.geckohomes.co.uk](http://www.geckohomes.co.uk)

Email:  
[sales@geckohomes.co.uk](mailto:sales@geckohomes.co.uk)

Call:  
0330 995 1333

**GECKO<sup>TM</sup>**

Total floor measurements shown are typical for these apartment types but should not be relied on when ordering carpets or fittings. Please ensure you take your own measurements. Floor plans, layouts and measurements are subject to change. The images shown within this brochure are for illustrative purposes only. All details shown within this brochure are subject to change and do not constitute part of a contract.